

Snow Guard

Design

Snow guards are designed according to roofing material, roof pitch, slope length, roof structure, and spacing of fixings. On long slopes, snow guards are placed in two or more rows. Snow guards should also be used on multi-level roofs.

The table below gives the maximum slope length from snow guard to ridge on smooth roof coverings. For coarse roofs the maximum lengths given in the table can be multiplied by 1.3 – 1.5.

Snow load (kN/m ²)	Maximum slope length (m)					
	1,8 kN/m ²			2,6 kN/m ²		
	Spacing of snow guard fixings (mm)			Spacing of snow guard fixings (mm)		
Roof pitch (α) (°)	600	900	1200	600	900	1200
α ≤ 15	18,0	12,0	9,0	12,5	8,3	6,2
15 < α ≤ 22	9,5	6,3	4,8	6,6	4,4	3,3
22 < α ≤ 27	7,0	4,7	3,5	4,8	3,3	2,4
27 < α ≤ 37	6,2	4,1	3,1	4,3	2,8	2,1
37 < α ≤ 45	7,5	5,0	3,7	5,2	3,5	2,6

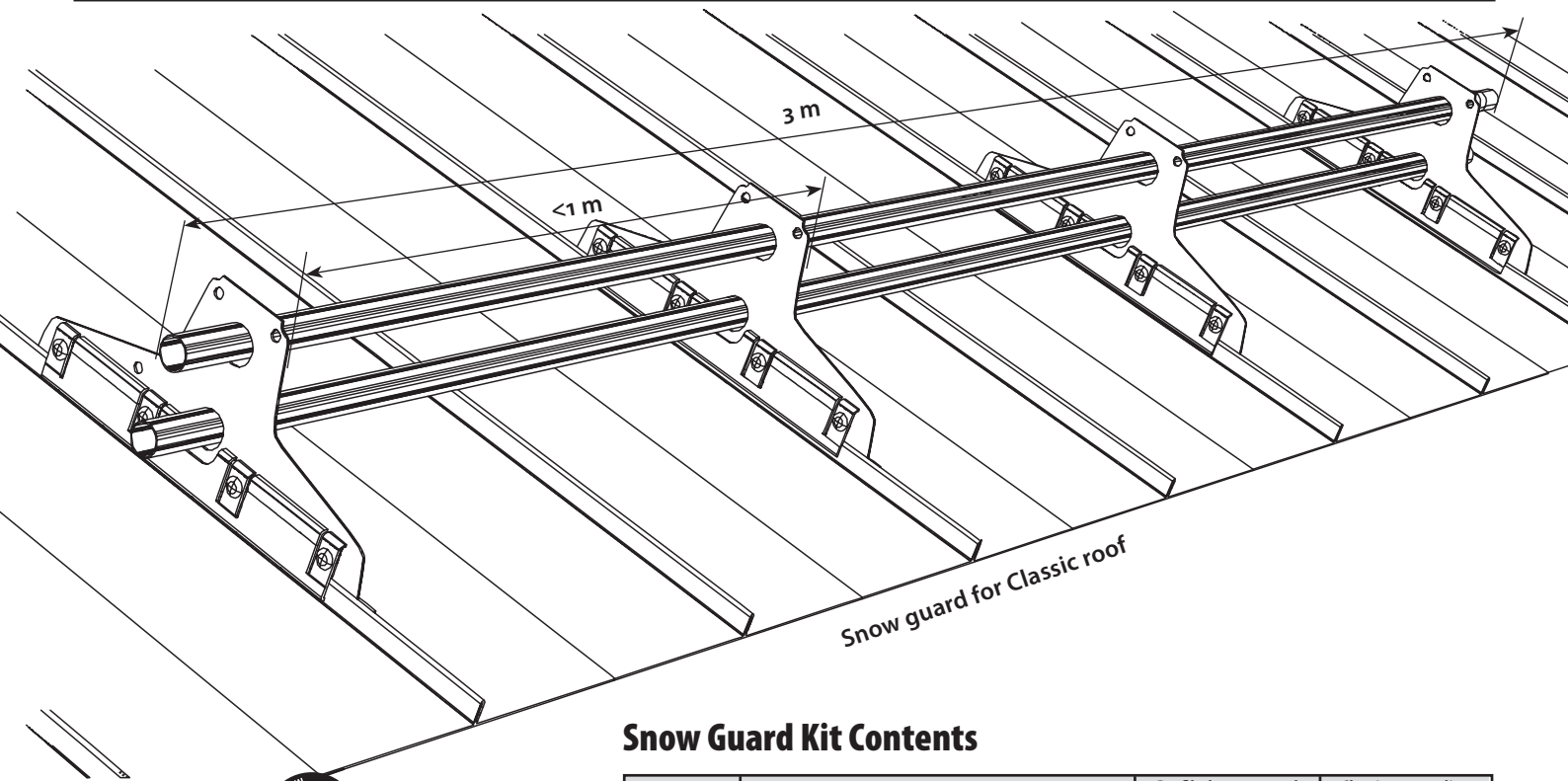

Snow Guard Kit Contents

Qty	Description	Profiled, corrugated or felt roofing	Classic or standing seam roofing
2	Snow guard tube, L = 3 m	X	X
4	Fixing	X	X
12	Rubber seal \varnothing 27 mm x 11 mm	X	
4	Support bracket		X
16	Carriage bolt (8 x 25) + nut (M8)		X
8	Coach screw 7 x 50	X	



The Tikli Group is certified for quality management and environmental management based on the ISO 9001 and ISO 14001 standards.

Snow Guard Installation

Installing the Fixings

Install the fixings to the roof structure, near the eaves and over a load-bearing wall, at maximum intervals of 1.0 m.

Profiled or Corrugated Steel Roofing, Felt Roofing

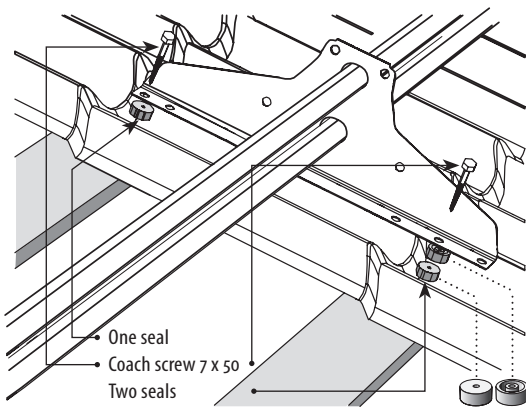

Attach the fixing to battens using one 7 x 50 mm coach screw at each end. Observe that the batten spacing varies according to roofing material. The fixing has holes for 300, 350 and 400 mm batten spacings. The fixing holes are sealed with rubber seals between the fixing and the roof. On profiled sheet roofs, the lower end must be equipped with two seals on top of each other.

Classic Seam Roofing

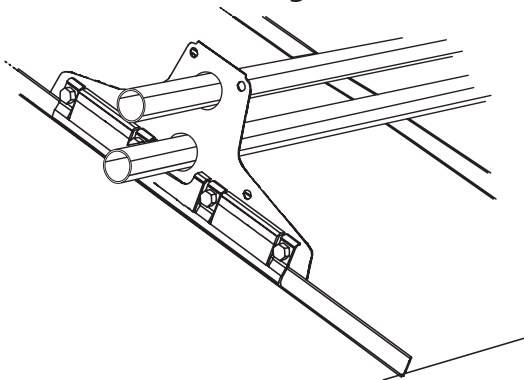

Install a fixing to every other vertical seam. Press the fixing against the seam using the supporting bracket and four 8 x 25 mm carriage bolts.

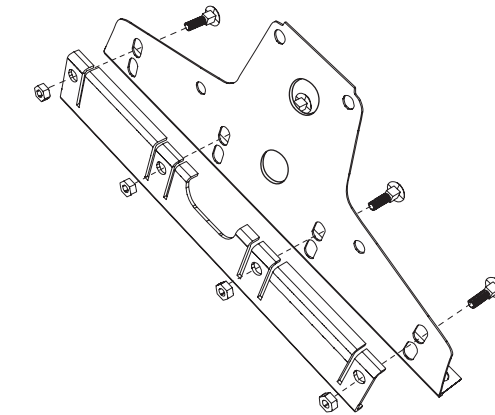
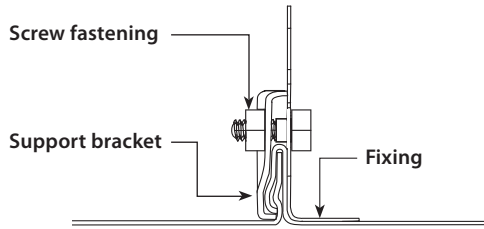

supporting bracket and four 8 x 25 mm carriage bolts. The bolt is correctly tightened when the nut is turned for another 2 to 3 rounds after the upper edge of the supporting bracket has reached the fixing.

Standing Seam Roofing

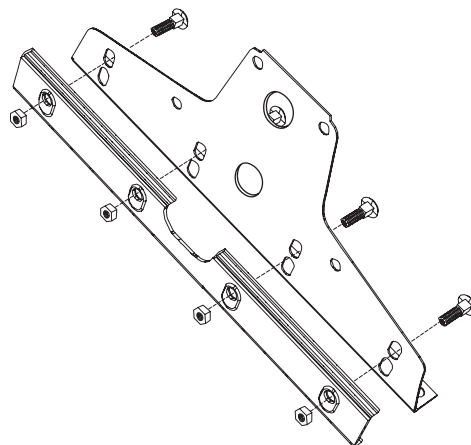

Install a fixing to every other vertical seam. Press the fixing against the seam using the supporting bracket and four 8 x 25 mm carriage bolts.

Installing and Extending the Snow Guard Tubes

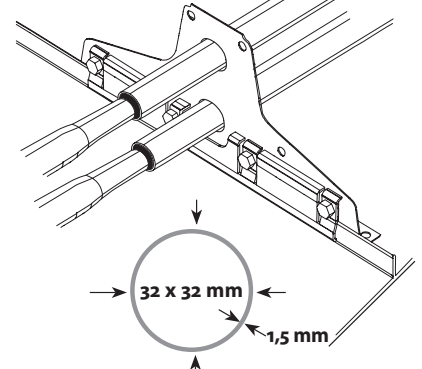

Place the tubes through the fixings. To extend the snow guard, insert the tapered end of each tube into another tube.

Maintenance

To ensure a long service life and safety, carry out the following maintenance procedures at least once a year:

- check the connections (bolt tension etc.)
- check the fixings
- check the tightness of the fixings
- remove excessive snow load, several times a year if necessary, to minimise stress on the structures and connections
- check the paint and the galvanised finish; touch up or refinish any damaged areas.



The Tikli Group is certified for quality management and environmental management based on the ISO 9001 and ISO 14001 standards.